

# **Rekluse Motor Sports**

## **TCS Forged Baskets**

**YFZ 450**

**2004 – 2006**

### **Installation Guide**

Copyright 2006 Rekluse Motor Sports

TCS Revision 1.000

RMS 4174

195-4174

Manual Revision: 101405

Rekluse Motor Sports, Inc.

110 E. 43<sup>rd</sup> Street

Boise, Idaho 83714

208-426-0659

[support@rekluse.com](mailto:support@rekluse.com)

## Required Tools To Assemble Basket

4mm allen key socket	Torque Wrench
----------------------	---------------

### Basket Overview

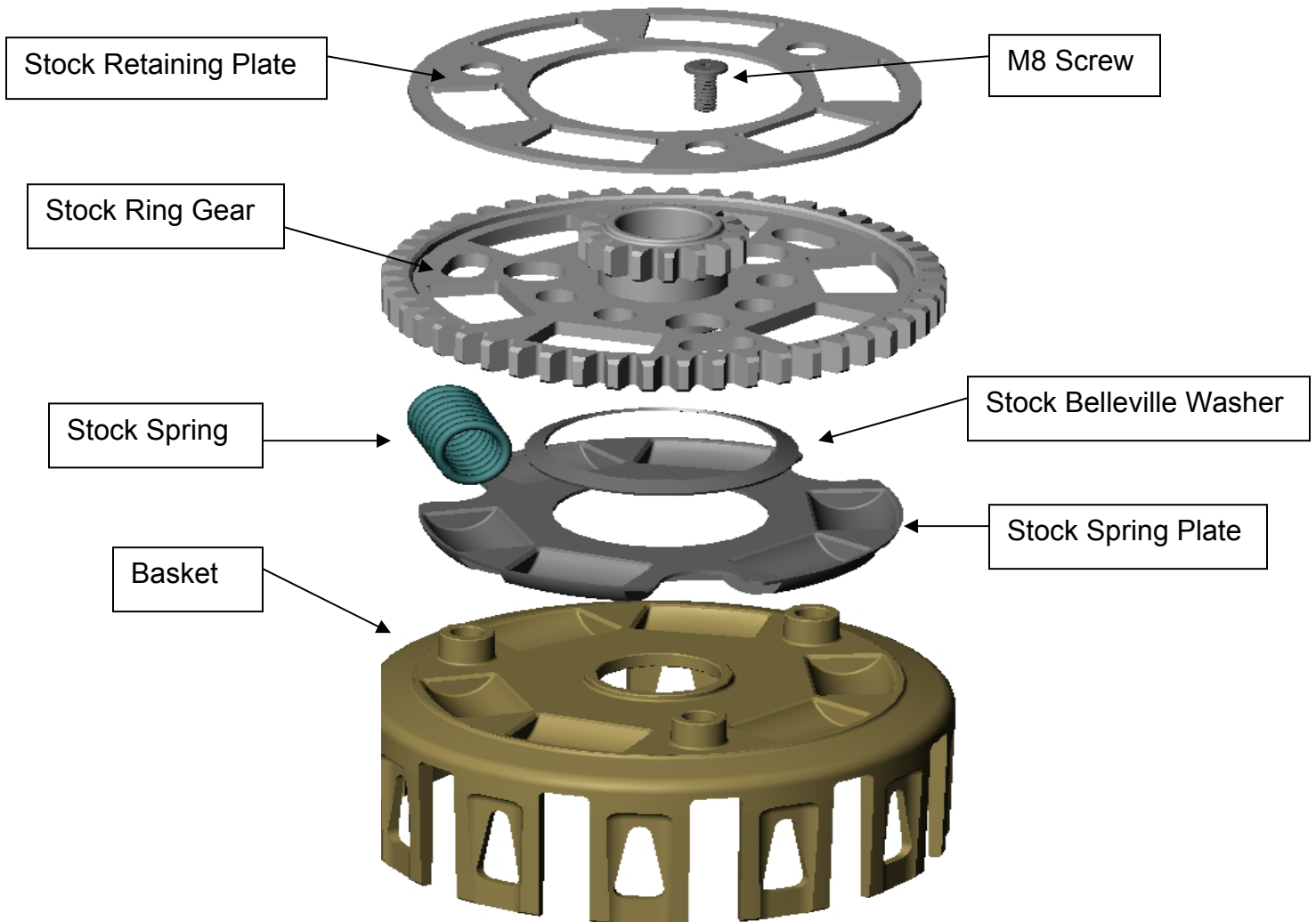

### Included Parts

Forged Basket Core	3 - M8 x 1.25 x 18 Socket Head Screws
--------------------	---------------------------------------

## Bike Preparation and Disassembly

1. Following the procedures in the OEM service manual, remove the existing clutch basket from the engine.

**Note:** It is a good idea to replace the side case cover gasket when re-installing the basket and clutch.

2. Remove the rivets holding the primary gear to the OEM aluminum clutch basket. The rivets can be removed by milling, drilling, or grinding the ends off, and pressing them out.

**Warning:** When removing the OEM rivets, do not damage the steel gear or retainer plate, as it will be used with your new Rekluse TCS Forged clutch basket.

3. Remove all components from the OEM basket, taking note of how everything will be reassembled.
4. Install the OEM spring plate, springs, Belleville washer, ring gear, and retainer plate onto the Rekluse TCS Forged clutch basket. **See Following Picture.**

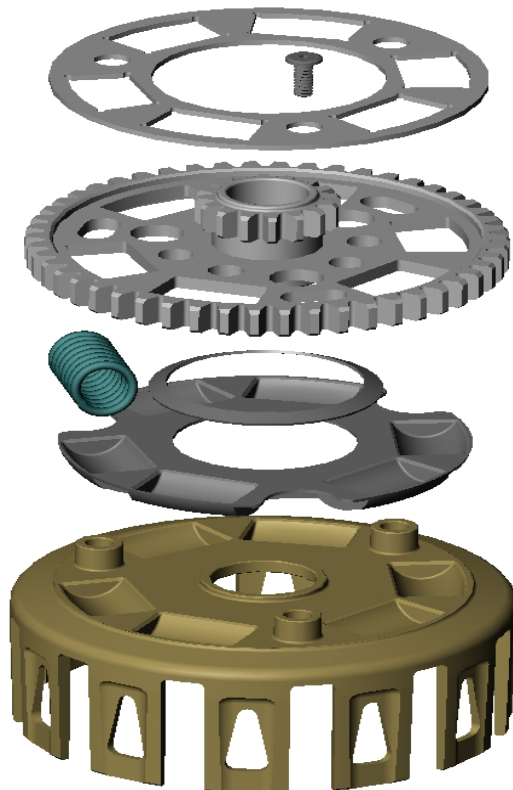

5. Install the 3 – M8 fasteners into the clutch basket assembly. Torque to 12 ft-lbs to compress the assembly evenly.
6. Using a hammer and punch, peen the ends of the screws where they come through the bottom-inside of the clutch basket. **See following picture.**



7. Install the new clutch basket assembly into the engine following the procedures in the OEM service manual.
8. For z-Start installation, refer to the z-Start Installation Guide that was included with the z-Start Clutch. For re-installing your stock clutch follow the procedures in the OEM service manual.