

REKLUSE TRAIL CLUTCH SETUP SHEET – RMS-1012

CLUTCH PACK CONFIGURATION

MODEL	QTY OF OEM FRICTION PLATES USED
CRF250R	5

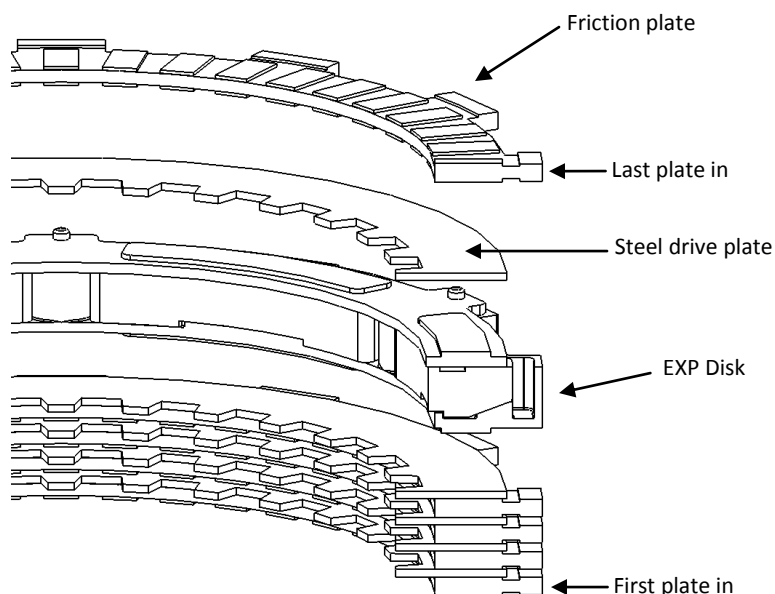

CRF250R: 5 OEM friction plates and 5 Rekluse Drive Plates

NOTE: '08-'09 CRF250R has a judder spring at the bottom of the stock clutch pack. This spring must be removed.

THROWOUT SPACER

MODEL	THROWOUT SPACER USED
CRF250R	Yes

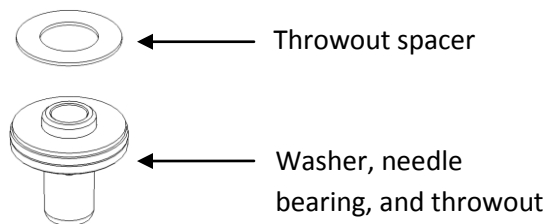

PRESSURE PLATE SPRINGS

MODEL	PRESSURE PLATE SPRINGS USED
CRF250R	5 Rekluse HD Springs

TUNING OPTIONS:

Included are 3 spring options to tune the engagement RPM of the EXP friction disk. The EXP friction disk comes set with the recommended “Medium” setting from Rekluse. See following chart.

CRF250R

ENGAGEMENT SETTING	SPRING CONFIGURATION
Low	3 Silver and 3 Red Springs
Medium	6 Red Springs
High	3 Blue and 3 Red Springs

NOTE: When using combinations of 3 and 3 sets of springs, you must stagger the different colored springs so the wedges are loaded evenly. For example, you will have 1 Red spring followed by 1 Blue spring until all 6 locations have one spring.

Adjusting the engine idle speed to match your engagement setting is important and greatly affects the overall feel of how the EXP friction disk engages. To prevent freewheeling and maximize engine braking, set the idle so there is a slight amount of drag while the bike is idling in gear and warmed up. The idle should not be so high as to move the bike forward in gear with the throttle closed. However, with a small opening of the throttle the bike should move forward.

To change springs, remove the 6 flat head screws with the included T-10 Torx tip. When re-installing screws, **use medium strength blue Loctite, and torque screws to 26 in-lbs.**

