

Rekluse Motor Sports

TCS Clutch Baskets

YZ250F/WR250F

2001 – 2008

Installation Guide

Copyright 2006 Rekluse Motor Sports

TCS Revision 1.000

RMS 4171

195-4171

Manual Revision: 6/22/06

Rekluse Motor Sports, Inc.

110 E. 43rd Street

Boise, Idaho 83714

208-426-0659

support@rekluse.com

Required Tools To Assemble Basket

4mm allen key socket	Torque Wrench
----------------------	---------------

Basket Overview

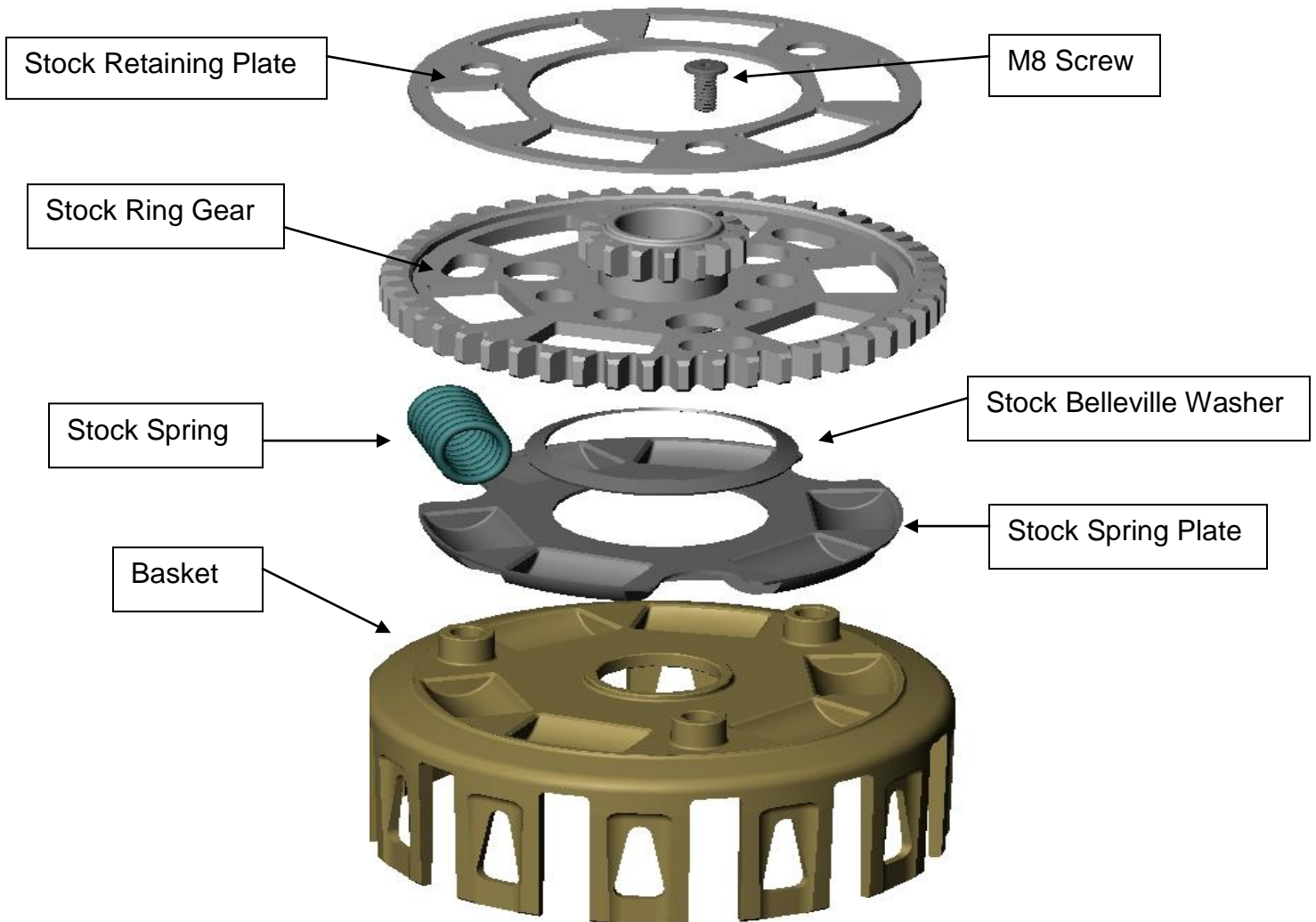

Included Parts

TCS Clutch Basket Core	3 - M8 x 1.25 x 16 Socket Head Screws
------------------------	---------------------------------------

Attention z-Start Users! With your new Rekluse Basket, you will need an updated pressure plate. Part#111-012B found engraved on top of pressure plate. If you did not receive an updated pressure plate please contact Rekluse.

Bike Preparation and Disassembly

1. Following the procedures in the OEM service manual, remove the existing clutch basket from the engine.
2. Remove the rivets holding the primary gear to the OEM aluminum clutch basket. The rivets can be removed by milling, drilling, or grinding the ends off, and pressing them out. **See following picture.**



Warning: When removing the OEM rivets, do not damage the steel gear or retainer plate, as it will be used with your new Rekluse TCS Clutch Basket.

3. Remove all components from the OEM basket, taking note of how everything will be reassembled.

4. Install the OEM spring plate, springs, Belleville washer, ring gear, and retainer plate onto the Rekluse TCS Clutch Basket.
See Following Picture.

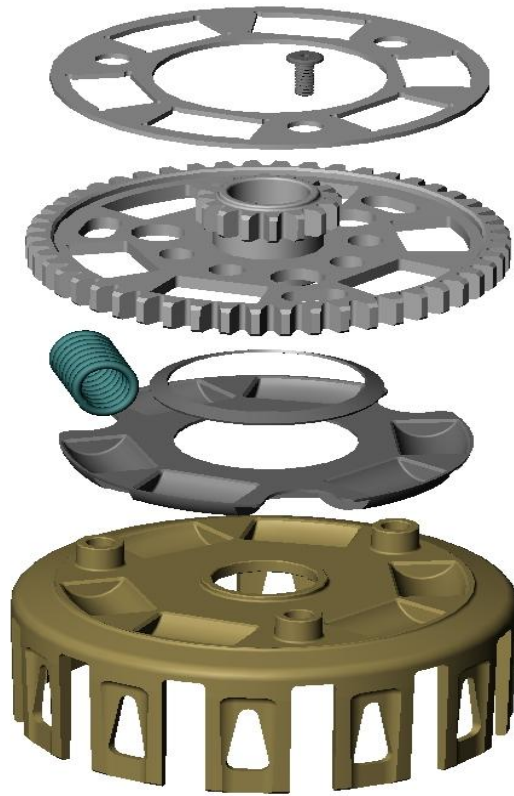

5. Install the 3 – M8 fasteners into the clutch basket assembly.
Torque to 12 ft-lbs to compress the assembly evenly.

6. Using a hammer and punch, peen the ends of the screws where they come through the bottom-inside of the clutch basket. **See following picture.**



WARNING: It is *critical* that you peen the ends of the screws or they can back out. Rekluse is not responsible for engine damage caused by screws that back out.

7. Install the new clutch basket assembly into the engine following the procedures in the OEM service manual.
8. For z-Start installation, refer to the z-Start Installation Guide that was included with the z-Start Clutch. For re-installing your stock clutch follow the procedures in the OEM service manual.